

PRODUCT FEATURES 1

1. Home version and arcade version 2 in 1. Home version support function with pause, save state, load state and play again next time. Arcade version has time-based billing mode and coin-based billing mode.
2. Support fast one key searching, classification by simulator and game type, Favorite games, recent games.
3. Support trackball for the original trackball games
4. Support adding gamepads for 3 and 4 player.
5. Support button definition, HD graphic mode, edit game list.
6. Support multi language switching(English, Spanish, Korean, Chinese).

USING MODE 1

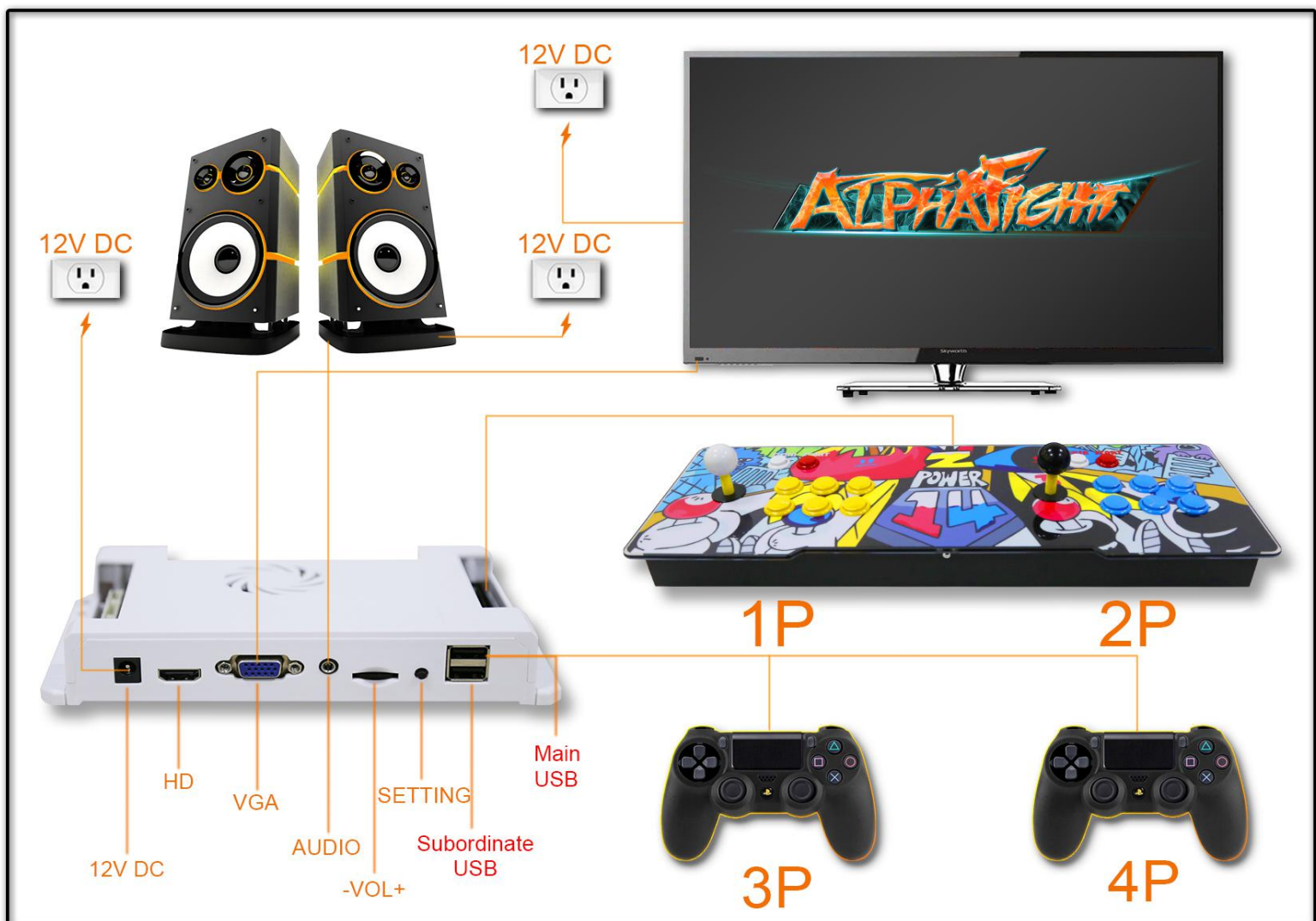

USING MODE 2



MAIN BOARD INTERFACE 2

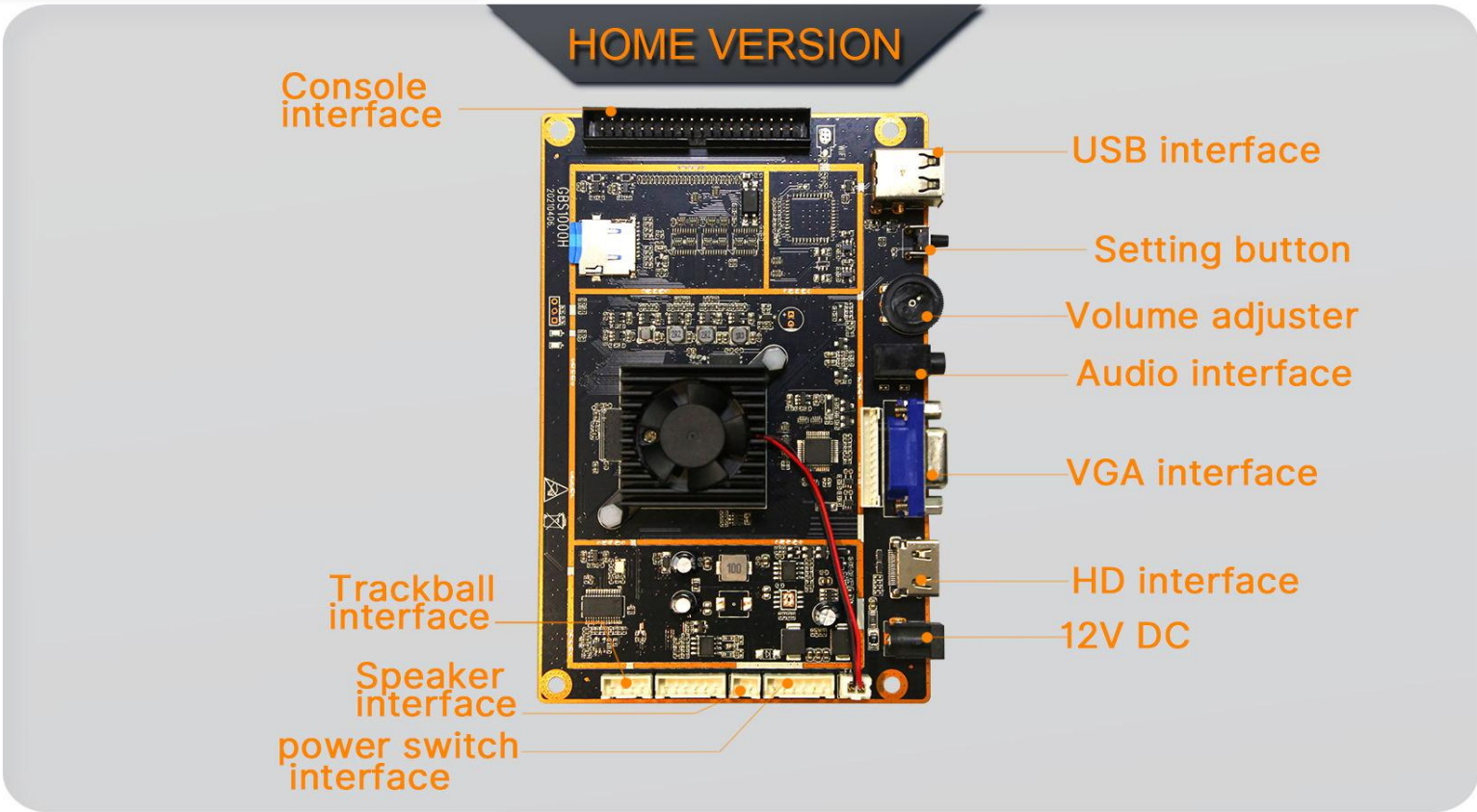

Motherboard Configuration	6 core processor, 4 core CPU+2 core GPU	
	CPU	ARM Cortex A7 4 core 1.3G
	GPU	Mali400MP2
	RAM	256MB
	SD Card capacity	16GB/32GB/64GB
Video Output	HDMI	1280X720 720P
	VGA	1280X720 720P

SYSTEM INTRODUCTION 3

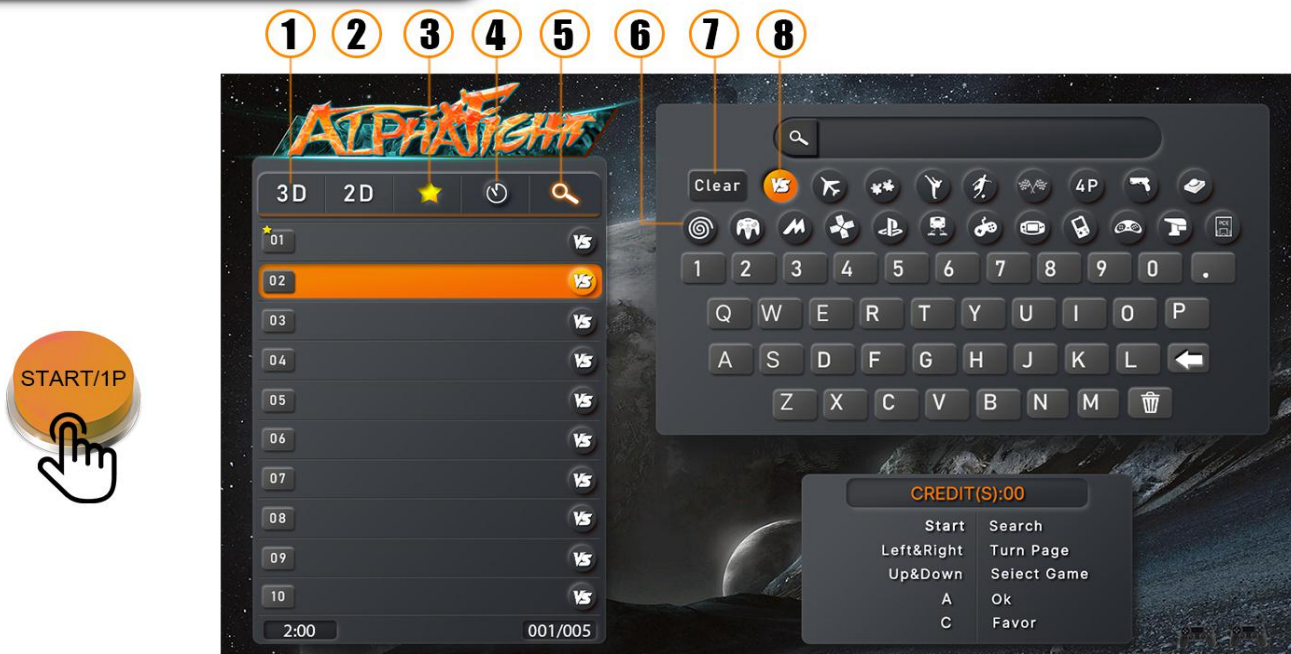

START button for quick action:

- ① ⑤ Fast switching between game list of 3D and Search.
- ⑤ ⑦ When you input letters to search,fast switching to search results,and then fast switching to clear results.

- ⑤ Game Search Function: Games can be searched by first letter.
- ③ Favourite games: Press C button to add games to the list,or remove them from the list.
- ④ Recently played games: Supports to save a list of 20 games that have been played recently.
- ⑦ Selected and then press A to clear result(Search or classification results).
- ⑥ Classification by simulator(DC,N64,MAME,PSP,PS1,FC,SFC,GBA,GBC,MD,FBA,PCE).
- ⑧ Classification by game type(Fighting,Shooting,Puzzle>Action,Sport,Racing,4P,Gun Shooting,Trackball).

Please press the setting button to enter the setting page. When settings have been changed, just press the START button to return to the game list home page, all the changes will be saved automatically.

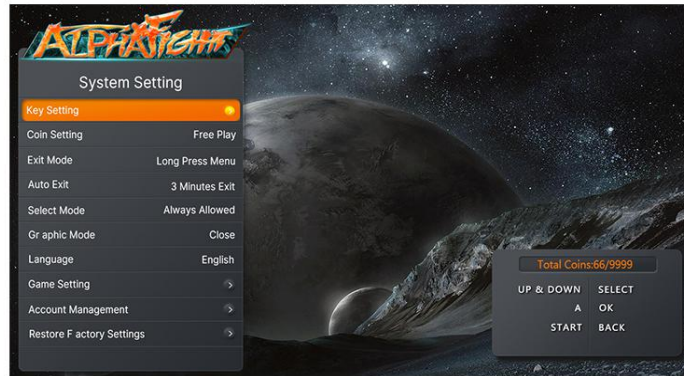

1 Key Setting:

- a) Key Testing: This item can test the using situation of joysticks, buttons and gamepads. The display icon is initially gray and yellow when pressed.
- b) Key Definition: This item can define the position of the buttons

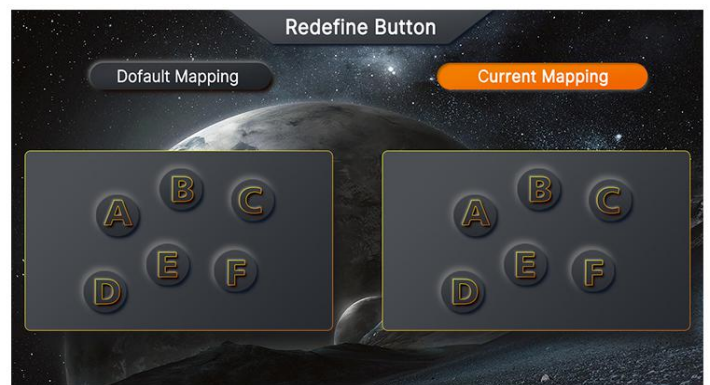

2 Coin Setting:

This item can set to free play or adjust the ratio of coins to credits, the ratio can be adjusted from 9:1 to 1:9. The following 3 4 5 items will only work in non free play mode.

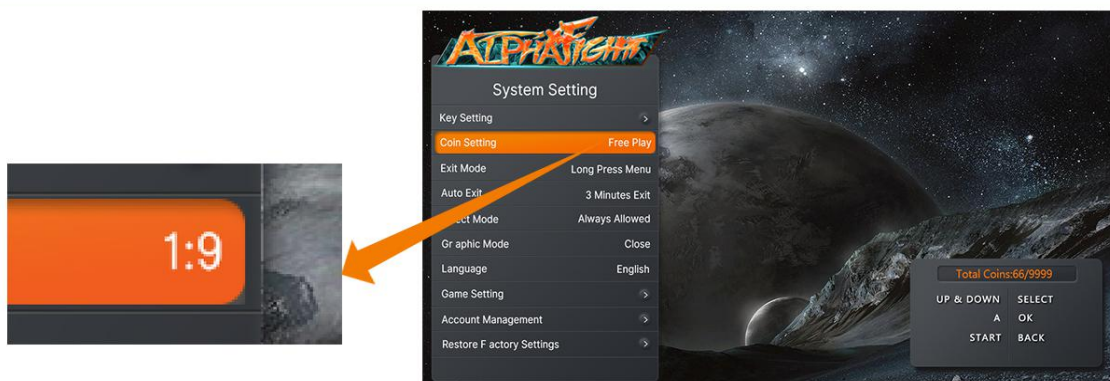

3 Exit Mode:

- a) Long Press Menu: Long press the START button to exit game.
- b) Start+Coin: Press the START button and insert a coin to exit game.

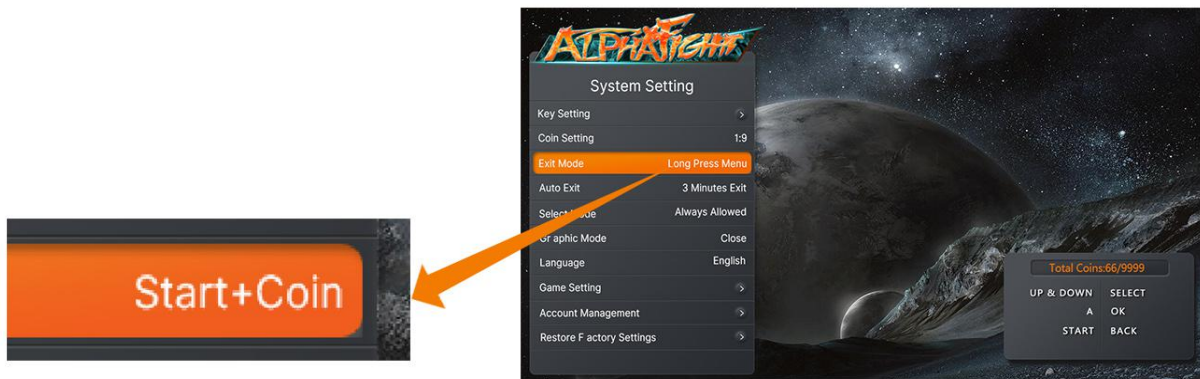

4 Auto Exit:

- 3 Minutes Exit: When the player does not operate the game within 3 minutes, the game will exit automatically.
- Closed: Not exit automatically.

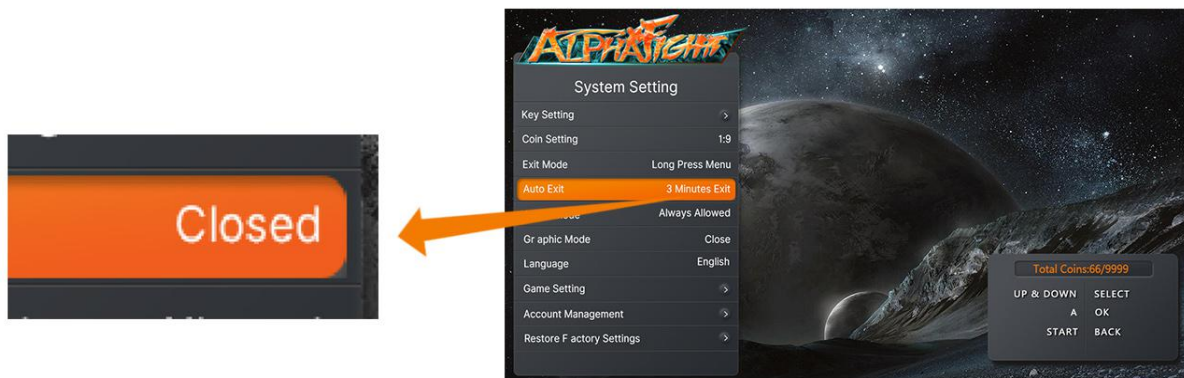

5 Select Mode:

- Always Allowed: Allowed to select games without any coins.
- Allowed After Insert Coins: Only Allowed to select games after you insert coin.



6 Graphic Mode:

Open: This will significantly improve the quality of the image in the game, but it will sacrifice a little bit of performance of some games

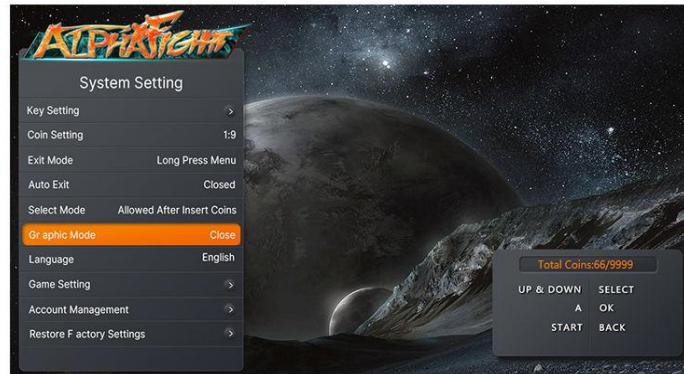

7 Language: It can be switched between English, Spanish, Korean, Simplified Chinese and Traditional Chinese.

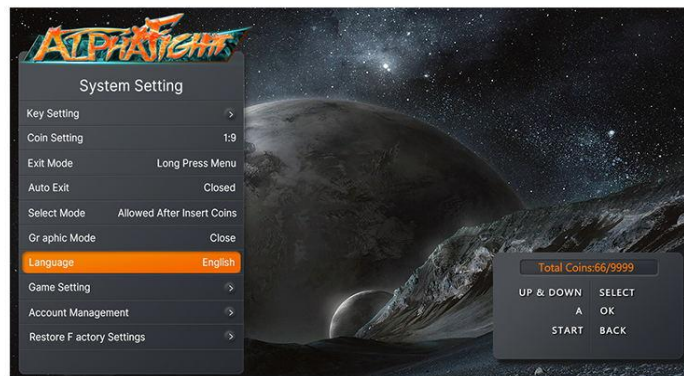

8 Game Setting:

a)Game Difficulty Setting: This item can change the difficulty and lives of some games, press A to adjust the difficulty value, press B to adjust the lives value, press C to apply to all games.

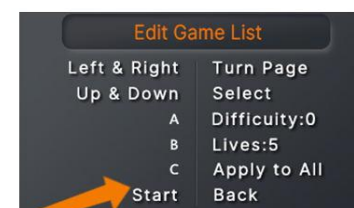
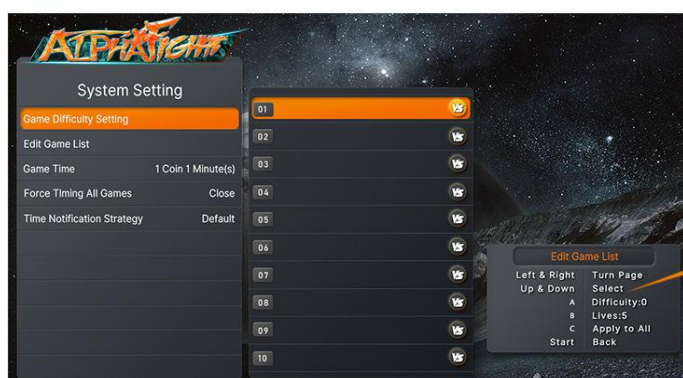

b) **Edit Game List:** This item can display or hide the games of home page, moving the joystick to select the game you want to hide, press A to hide or display the game, press B to hide all games, press C to display all games.



c) **Game Time:** This item will only work in console games and non free play mode. This is the ratio of coins to credits, the ratio can be adjusted to 1 credit (1,2,3,5,10,20,30) minute(s).

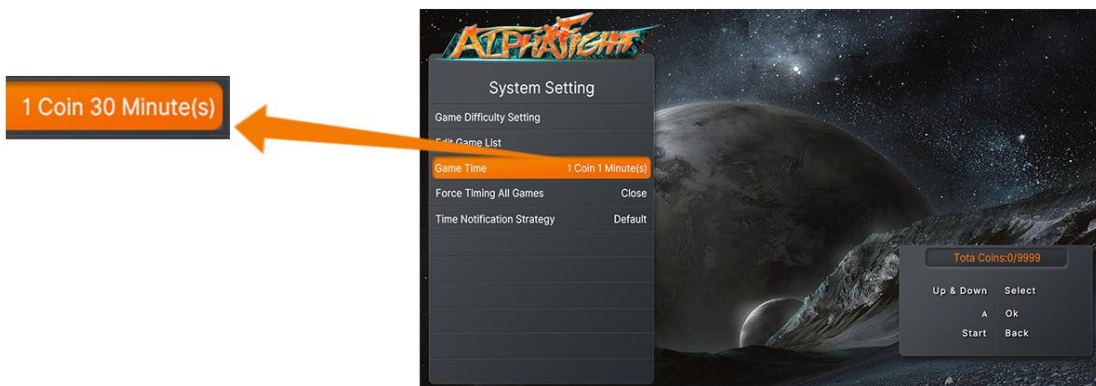

d) **Force Timing All games:**
 Open: This will force the arcade games to operate through timer.
 Close: Arcade games operate through coin, Console games operate through timer.

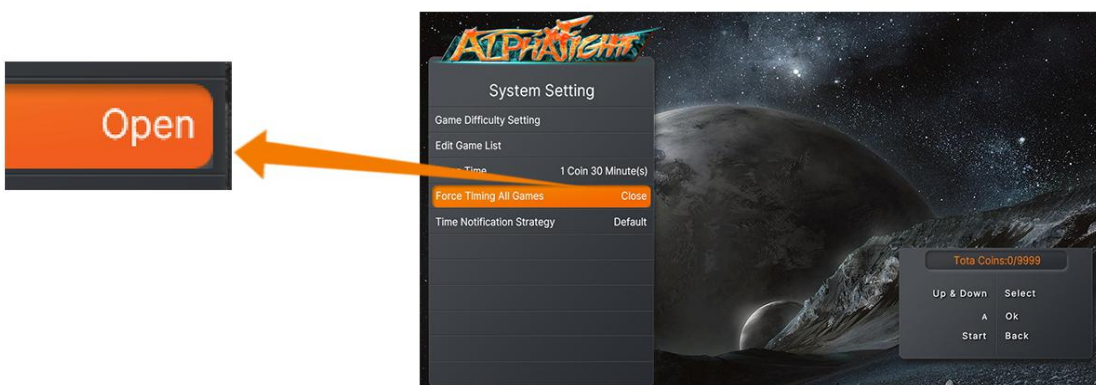

e) Time notification Strategy:

Open: The remaining time will always show on the top of screen during game.

Close: The remaining time will only show when press the START button.



9 Account Management: Default password is 1111111.

a) Clear Coins: This need to input current password, Once completed, this will clear the total currency of operating revenue and cannot be recovered.

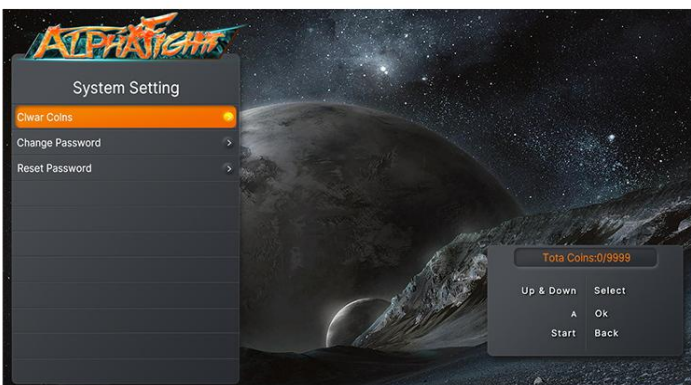

b) Change Password: Please remember the new password when done. Once you forget the password, there is no way to get it back even factory reset. You can only return it to the factory for maintenance.

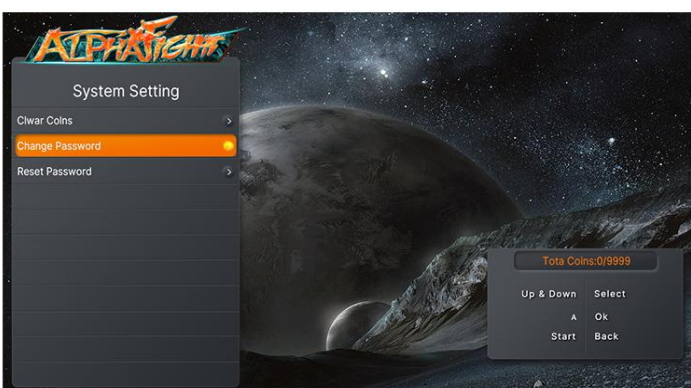

c) **Reset Password:** Input current password to reset the password to default.

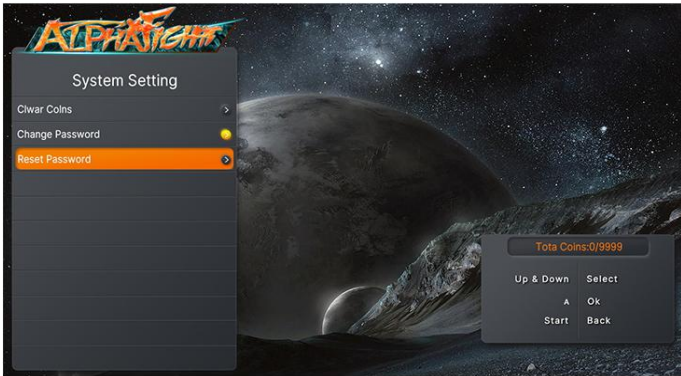

10 **Restore Factory Settings:** If you need to restore the factory settings, please select the factory reset option and press the A button to confirm. This will not restore the account management settings.

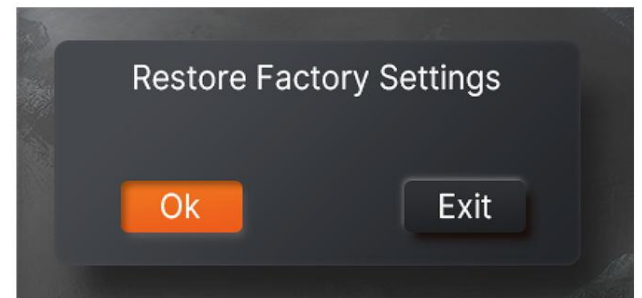
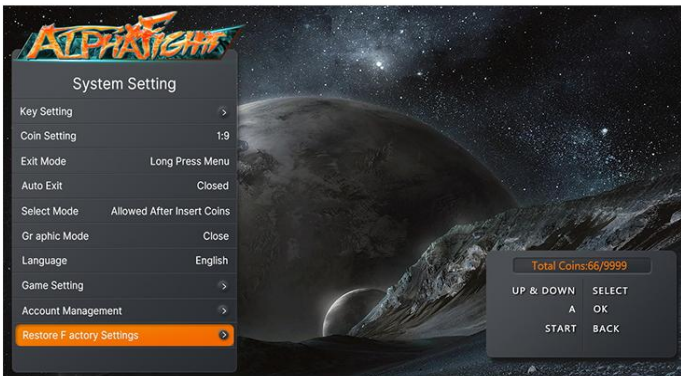

FAULT DESCRIPTION	FAULT FACTORS	TROUBLESHOOTING
No response after power on and the power light is tno on	1.Power adapter is abnormal 2.Main board is abnormal	Change the power adapter of the same parameters or contact your supplier
No image signal	Please check whether the HD cable or VGA cable is well connected , and whether the screen monitor signal source setting is normal	Change the Video cable or the monitor
No sound	The wire is abnormal	Change the wire or audio device
No games when boot up	Poor connection of memory card	Reseat the memory card
The key's function is disordered	Wrong keys wiring	Please refer to the key wiring diagram on the instruction manual
The keys suddenly fail during operating	The keys wire is loosen	Please contact to your supplier or open the joystick controller box to check the wire



Moonlight Treasure Box	1P	2P	Moonlight Treasure Box
+5V	1	1	+5V
NC	2	2	NC
NC	3	3	NC
NC	4	4	NC
NC	5	5	NC
2P-F	6	6	2P-F
2P-E	7	7	2P-E
2P-D	8	8	2P-D
2P-C	9	9	2P-C
2P-B	10	10	2P-B
2P-A	11	11	2P-A
2P-right	12	12	2P-right
2P-left	13	13	2P-left
2P-down	14	14	2P-down
2P-up	15	15	2P-up
2P-start	16	16	2P-start
Pause	17	17	Pause
Ground	18	18	Ground
	19	19	
NC	20	20	NC



Have Fun!